

### 1 Installation and Startup Guide

This document covers the installation of cMT3072X2/3072XH2 Series HMI, for the detailed specifications and operation, please refer to Datasheet, Brochure and EasyBuilder Pro User Manual. Please read all warnings, precautions, and instructions on the device carefully before use.

#### Install Environment:

NEMA Rating	The HMI product is NEMA 4 rated (Indoor Only).
Electrical Environment	The HMI product has been tested to conform to European CE requirements. This means that the circuitry is designed to resist the effects of electrical noise. This does not guarantee noise immunity in severe cases. Proper wire routing and grounding will insure proper operation.
Environmental Considerations	<ol style="list-style-type: none"> <li>(1) Make sure that the displays are installed correctly and that the operating limits are followed. Avoid installing units in environments where severe mechanical vibration or shocks are present.</li> <li>(2) Do not operate the unit in areas subject to explosion hazards due to flammable gases, vapors or dusts.</li> <li>(3) Do not install the unit where acid gas, such as SO<sub>2</sub> exists.</li> <li>(4) This device should be mounted in the vertical position and for use on the flat surface enclosure.</li> <li>(5) For use in Pollution Degree 2 Environment and dry location.</li> <li>(6) Relative Humidity: 10% ~ 90% (non-condensing)</li> </ol>
Cleaning Considerations	Clean the device using dry cloths. Do not use liquid or spray detergents for cleaning.
IP Rating	IP 66
 Warning	Protection impairment if used in a manner not specified by the manufacturer. Déficit de protection si utilisé d'une manière non spécifiée par le fabricant.

### 2 Unpacking the Unit

Unpack and check the delivery. If damage is found, please contact the supplier.

**NOTE: Place the operator panel on a stable surface during installation. Dropping it or letting it fall may cause damage.**

The package includes:

- (1) Installation Instruction, 2-sided A4 \*1
- (2) Human Machine Interface \*1
- (3) Power Connector \*1
- (4) Brackets & Screws \*1 pack
- (5) USB Stick Clamp & Tying Strap \*1

#### USB Stick Clamp Usage

Combining the USB Stick with the clamp and the tying strap can prevent USB stick from disconnecting with HMI when strong vibration is present.

1. Insert the USB connector to the clamp and tie them together with the tying strap.
2. Press the spring and insert the USB stick into HMI.

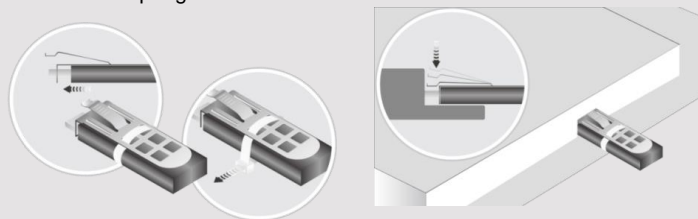

### 3 Installation Instructions

Use a control box that provides enough space for the operator panel in position, using all the provided brackets and screws. The control box should be 2.6 ~ 3.9 lbf.in. (For reaching waterproofing) preventing the panel from being deformed. Plan for adequate space around the unit enclosure, for ventilation and cables. Avoid heat from other devices inside the enclosure. Maintain ambient temperature around the unit. Minimum required clearances (along top) 15 mm / Bottom 50 mm / Sides 15 mm. Maximum panel thickness: 4.5 mm.

### 4 Power Connections

Power Connector Specifications:  
 Wire AWG: 24~12  
 Wiring Conductor Minimum Temperature: 0°C  
 Screw Torque: 4.5 lbf-in (max.)  
 Copper conduct only.

#### NOTE:

1. Connect positive DC line to the '+' terminal.
2. When downloading project using EasyBuilder Pro with PLC and PC simultaneously, for safety, result in damage to HMI or PC.

### 5 System Settings

When the HMI powers up and displays the main screen, tap "Settings" to open the Setting page. To configure the system, tap "configure" or later, tap "configure", and a login window will appear. Enter the system password (default: 111111). If the password is correct, tap "login" and log in to make changes. In the Settings page, tap "System" settings, set HMI Time/Date/Name, and tap "OK".

### 6 EasyBuilder Pro Software

Launch EasyBuilder Pro software, select "Ethernet" in the dialog box: Select Ethernet > IP tab > "Configure" to connect to HMI.

Using screensaver and backlight save power by displaying the same image on HMI. (Please refer to EasyBuilder Pro User Manual for details.)

## 7 Communication Connections

### NOTE:

1. COM2 and COM3 [RS485] 2W support MPI 187.5K, please use one at a time.
2. Only Tx & Rx (no RTS/CTS) may be used for COM1 RS232 when COM3 RS-232 is also used.
3. CAN Bus is not supported on cMT3072X2.

1 2 3 4 5  
6 7 8 9 **Con.B**

COM1/COM3 [RS232] 9 Pin, Male, D-sub

PIN#	COM1 [RS232]4W	COM3 [RS232]2W
1		
2	RxD	
3	TxD	
4		
5	GND	
6		
7	RTS	TxD
8	CTS	RxD
9	GND	

5 4 3 2 1  
9 8 7 6 **Con.A**

COM2/COM3 [RS485]/CAN Bus 9 Pin, Female, D-sub

PIN#	COM2 [RS485]2W	COM2 [RS485]4W	COM3 [RS485]2W	CAN Bus
1	Data-	Rx-		
2	Data+	Rx+		
3		Tx-		
4		Tx+		
5	GND			
6			Data-	
7				CAN_L
8				CAN_H
9			Data+	

## 8 Restore Factory Default

There are two methods to restore factory default, both of which will erase all project files and data stored on the device.

1. Follow the instructions in section 5 of this manual to open the Setting page and select the appropriate page based on the OS version before pressing "Reset HMI to default":  
For OS versions 20231201 or later, select the "System Properties" page, press "Reset HMI to Default," and select "Reset".  
For OS versions before 20231201, select the "Reset Options" page, press "Reset HMI to default", and enter "yes".
2. Alternatively, during login, enter "default111111".  
For OS versions 20231201 or later, select "Reset".  
For OS versions before 20231201, enter "yes".

## 9 Battery Replacement

Battery Specification: Type CR2032, Rated 3V

Battery replacement shall be performed by qualified personnel (engineer) only and care must be taken when handling lithium batteries. For more information on battery replacement and disposal considerations, please refer to the following link:

[http://www.weintek.com/download/MT8000/eng/FAQ/FAQ\\_103\\_Replace\\_Battery\\_en.pdf](http://www.weintek.com/download/MT8000/eng/FAQ/FAQ_103_Replace_Battery_en.pdf)

### CAUTION



Power

**NOTE:** Make  
installing the u

Use power output  
powered by DC p  
systems. The pow  
supply. The peak s

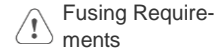

Fusing Require-  
ments

If the display does  
will protect against  
of time. Check wiri

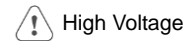

High Voltage

A resettable fuse  
DC voltage source

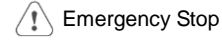

Emergency Stop

A Hard-wired EME  
ICS Safety Recom

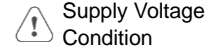

Supply Voltage  
Condition

Do not power the e  
power supply. Note  
power the unit.

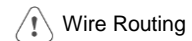

Wire Routing

- a. Power wire ler
  - b. Please use tw
  - c. If wiring is to b
  - d. Keep AC, high
  - e. Add a resistor
- supply and the  
dissipation. Ty

### DANGER

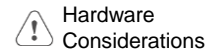

Hardware  
Considerations

The system desig  
thereby create a  
interface can lea  
physical injury to t  
If you use any pr  
potential safety ha  
steps depend on  
installation of soli  
installation of Con

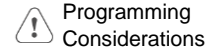

Programming  
Considerations

To conform to ICS  
ensure that all wr  
checks built into th  
personnel.

## Limited Warranty

This product is limited warranted ag  
The proven defective product will e  
This warranty shall not cover any p  
(a) Out of warranty period which is 12 month  
(b) Damage caused by Force Majeure, accid  
(c) Product has been repaired or taken apar  
(d) Products whose identification markings h